

# Now Selling Phase II Home Sites!

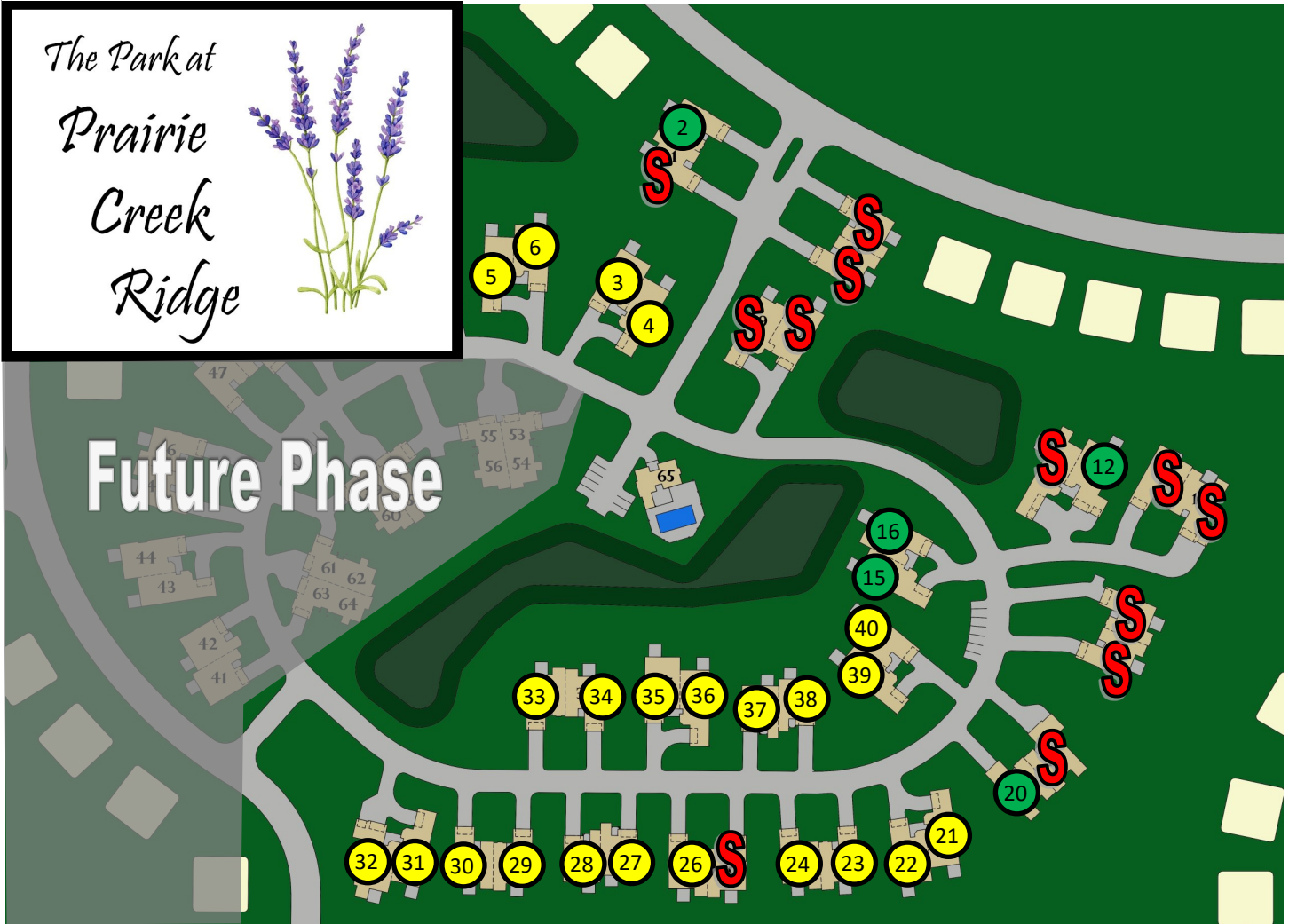

## Community Pool and Club House

## 3-Car Garage Options

## Sunroom Options

### Directions

I-94 to Hwy 16; West to Hwy P (Brown St.); North to Whalen Dr. (west side); West to Prairie Creek Circle / entrance to Subdivision on the left.

Coordinates—43°08'06.6"N 88°28'07.1"W

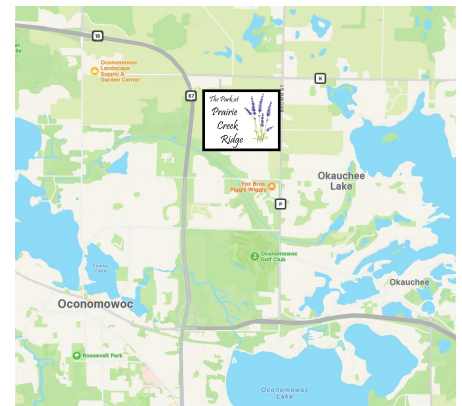

~ EFFECTIVE 1/1/2026 **S** SOLD    **●** Move-in Ready    **●** To Be Built 2026

*Continual improvement of design and construction requires that all specifications, finishes, and equipment remain subject to change without notice*



Unit #	Plan Type	Exposure	Sunroom	Garage	Price
2	Cypress	N/A	N/A	2-Car	<b>\$599,000—Move-in Ready NOW!</b>
3	Emory	N/A	Available	2-Car	Starting at \$684,900
4	Dalea	N/A	Available	3-Car Available	Starting at \$664,900
5	Dalea	N/A	Available	3-Car Available	Starting at \$664,900
6	Emory	N/A	Available	2-Car	Starting at \$684,900
12	Emory	N/A	N/A	3-Car	<b>\$679,900—Move-in Ready NOW!</b>
15	Dalea	Partial	N/A	2-Car	<b>\$684,900—Move-in Ready NOW!</b>
16	Emory	Partial	N/A	2-Car	<b>\$694,900—Move-in Ready NOW!</b>
20	Cypress	Partial	Included	2-Car	\$694,900—Move-in April 2026
21	Emory	Partial	Available	3-Car Available	Starting at \$719,900
22	Dalea	Partial	Available	3-Car Available	Starting at \$699,900
23	Cypress	Partial	Available	3-Car Available	Starting at \$679,900
24	Cypress	Partial	Available	3-Car Available	Starting at \$679,900
26	Cypress	Partial	Available	3-Car Available	Starting at \$679,900
27	Cypress	Partial	Available	3-Car Available	Starting at \$679,900
28	Cypress	Partial	Available	3-Car Available	Starting at \$679,900
29	Cypress	Partial	Available	3-Car Available	Starting at \$679,900
30	Cypress	Partial	Available	3-Car Available	Starting at \$679,900
31	Dalea	Partial	Available	3-Car Available	Starting at \$699,900
32	Emory	Partial	Available	3-Car Available	Starting at \$719,900
33	Cypress	Partial	Available	3-Car Available	Starting at \$679,900
34	Cypress	Partial	Available	3-Car Available	Starting at \$679,900
35	Emory	Partial	Available	3-Car Available	Starting at \$719,900
36	Dalea	Partial	Available	3-Car Available	Starting at \$699,900
37	Barberry	Partial	Available	3-Car Available	Starting at \$649,900
38	Barberry	Partial	Available	3-Car Available	Starting at \$649,900
39	Dalea	Partial	Available	3-Car Available	Starting at \$699,900
40	Emory	Partial	Available	3-Car Available	Starting at \$719,900

## The Park at Prairie Creek Ridge Condominium Base Price List

Barberry	1,570 SF	\$614,900
Cypress	1,760 SF	\$644,900
Dalea	1,878 SF	\$664,900
Emory	1,942 SF	\$684,900

Optional 168 SF Sunroom	\$30,000
Optional 3-Car Garage	\$20,000
Partial Exposure with Deck	\$35,000

~ EFFECTIVE 1/1/2026 [www.kingswayhomes.com](http://www.kingswayhomes.com) 262-797-3636

*Continual improvement of design and construction requires that all specifications, finishes, and equipment remain subject to change without notice*